

R²

RESIDENCE²



WINDOWS & DOORS

THE WAY THEY'RE
MEANT TO BE™



RESIDENCE²

SQUARED.

THE RESIDENCE COLLECTION ARE PIONEERS IN THEIR FIELD, DEVELOPING WINDOW AND DOOR SYSTEMS WITH TECHNOLOGY AND INNOVATION AT THE FOREFRONT.

R² IS THE ARCHITECTURAL HIGHLIGHT OF THE COLLECTION, WITH CLEAN LINES AND SUPERB PERFORMANCE.





STUDIO²

THE CLEAR CHOICE.



VERY CLEAR IN ITS' DESIGN. WITH A CUTTING
EDGE INTERNAL SHAPE IT IS UNCONVENTIONAL
AND UNIQUE.



DESIGNER²

THE BOLD CHOICE.



STRAIGHT LINED INNOVATION. BOLD LOOKS
CREATE A BRIGHT LIVING ENVIRONMENT.



CONVERT²
THE ELEGANT CHOICE.

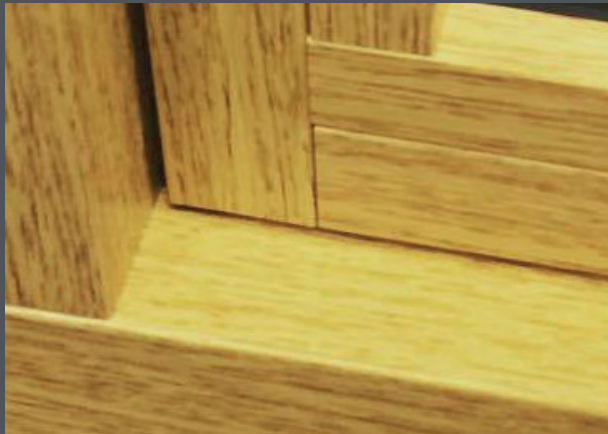

FEELS ELEGANT AND TIMELESS. FOR THOSE WANTING A CONTEMPORARY LOOK IN A TRADITIONAL BUILDING.

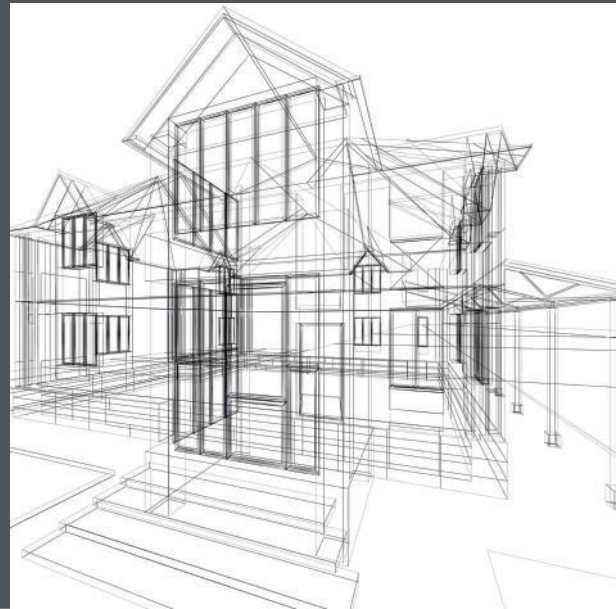

BUILD²
THE DREAM CHOICE.



COMPLETE YOUR DREAM PROJECT. SIMPLICITY STANDS OUT; SQUARE DETAIL.





WINDOWS & DOORS
THE WAY THEY'RE
MEANT TO BE™

R²

COLOUR CHOICE

DESIGN INSPIRATION.

YOUR HOME, YOUR CHOICE.

RESIDENCE² COLOUR PALETTE HAS BEEN REFINED TO REFLECT MODERN, YET TIMELESS TONES, SO YOU CAN TAILOR THE COLOUR AND DESIGN TO YOUR HOME.

FOR MORE COLOUR INSPIRATION, VISIT WWW.RESIDENCECOLLECTION.CO.UK/GALLERY OR SEARCH INSTAGRAM AND PINTEREST #RESIDENCECOLLECTION.



PAINSWICK



ECLECTIC
GREY

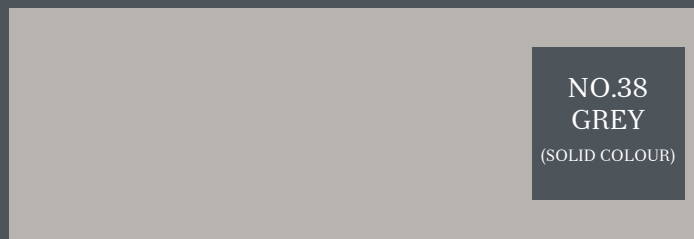
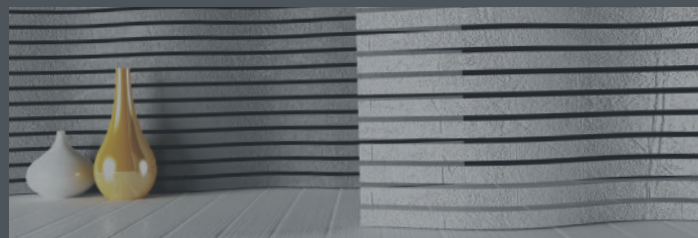

NO.38
GREY
(SOLID COLOUR)

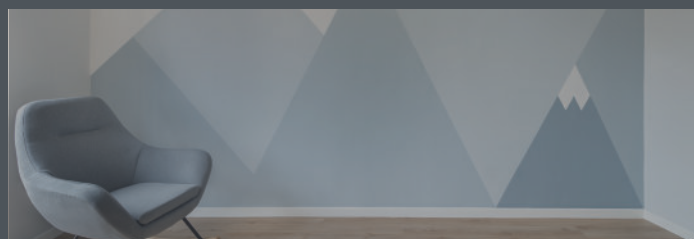

GRAINED
WHITE

VINTAGE
CREAM
(SOLID COLOUR)



CHALK
WHITE
(SOLID COLOUR)

CLOTTED
CREAM



IRISH
OAK

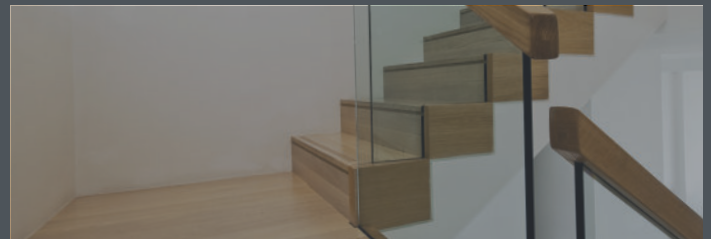

ENGLISH
OAK



SILVERED
OAK







RESIDENCE²

YOUR CHOICE.

“
We chose
R² as it
has a very
clean &
modern
aesthetic
”

The Hargreaves.

R²



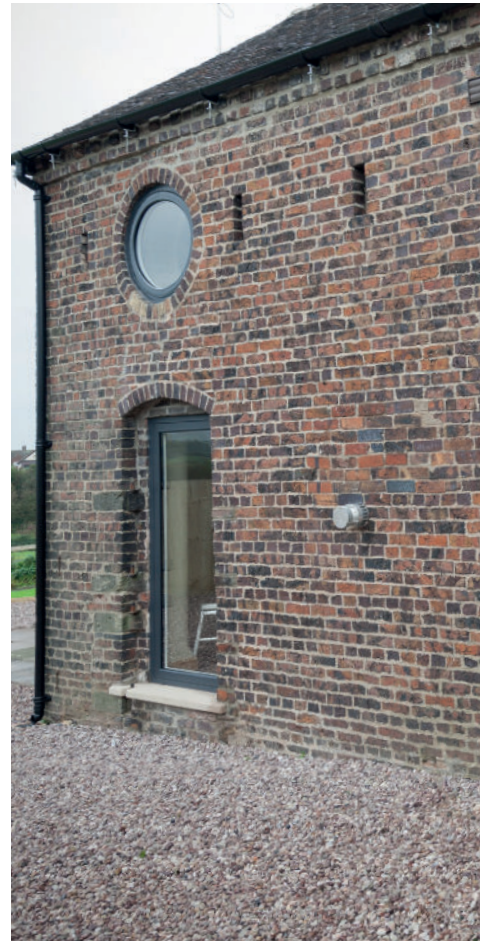

WINDOWS & DOORS
THE WAY THEY'RE
MEANT TO BE™

R²

MARKET LEADING

PERFORMANCE.

ENERGY EFFICIENCY

R² HAS MARKET LEADING THERMAL AND ACOUSTIC VALUES. CERTIFIED WITH A WINDOW ENERGY RATING OF A⁺⁺ IT ACCOMMODATES THE MOST THERMALLY AND ACOUSTICALLY EFFICIENT 44MM TRIPLE GLAZING AND 28MM DOUBLE GLAZING, ATTAINING U-VALUES OF 0.79 W/M²K WITH TRIPLE GLAZING, PASSIVHAUS STANDARD AND 1.2 WITH DOUBLE GLAZING, FAR SURPASSING THE BRITISH BUILDING REGULATION REQUIREMENTS.

TESTING & SECURITY

R² ACHIEVES ONE OF THE HIGHEST CLASSIFICATIONS ON THE BRITISH STANDARD WEATHER TEST. IT HAS ALSO PASSED ALL SECURITY TESTS, THE GLAZING BEAD IS ALWAYS ON THE INSIDE WHICH CONTRIBUTES TO A HIGHER SECURITY PERFORMANCE.



A⁺⁺
ENERGY RATING
0.79 W/m²k
U-VALUE



INNOVATIVE DESIGN.

28MM
DOUBLE GLAZING

44MM
TRIPLE GLAZING

EQUAL SIGHT-LINES

R² IS BUILT TO UNQUESTIONABLE MARKET LEADING DESIGN STANDARDS, THIS EFFECTIVE AND HIGH PERFORMANCE SOLUTION OFFERS CLEAN LINES AND ADVANCED FUNCTIONALITY. AN ELEGANTLY FLUSH SASH EXTERIOR AND A UNIQUE SQUARE INTERIOR GIVES RESIDENCE² ITS BOLD AND MODERN APPEARANCE. ALL GLASS SIGHT-LINES ARE PERFECTLY EQUAL PROVIDING SYMMETRY, COMPLEMENTING THE INTERNAL STYLISH SQUARE DETAIL.

LOCK & HINGE RETENTION

R² BOASTS SUPERIOR SCREW RETENTION REINFORCEMENTS, LOCKS AND HINGES ARE SECURED FIRMLY INTO POSITION. IT IS ALSO SPECIFICALLY DESIGNED TO ACCOMMODATE THE ADDITIONAL WEIGHT OF TRIPLE GLAZED UNITS, ALLOWING HEAVY DUTY HINGES TO FIT AND OPERATE PERFECTLY.

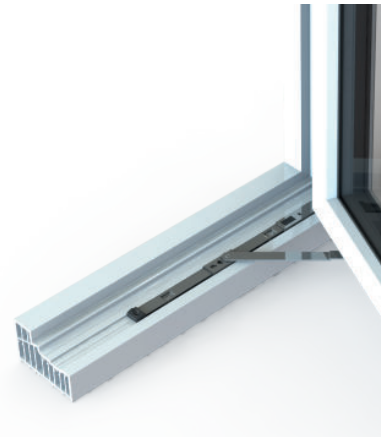

R²

FUTURISTIC

BUILT TO LAST.

MAINTENANCE FREE

PVCU IS AN INSULATING MATERIAL, KEEPING YOU COSY IN THE WINTER AND COOL IN THE SUMMER, CONTRIBUTING TO LOWER ENERGY BILLS AND CARBON EMISSIONS. ALL OUR WINDOWS AND DOORS CAN BE FULLY RECYCLED UP TO 20 TIMES, MEANING A LIFE SPAN OF OVER 300 YEARS AND WE ACTUALLY INCLUDE A RECYCLED MATERIAL SECTION WITHIN THE PROFILES. AS FOR MAINTENANCE, THERE'S VERY LITTLE, NO TOXIC PAINTS, PRIMERS, PRESERVATIVES OR FUNGICIDES TO KEEP YOUR WINDOWS LOOKING NEW; A SIMPLE WIPE CLEAN WILL DO THAT.

9 CHAMBER DESIGN

R² HAS BEEN ENGINEERED TO MEET CURRENT AND ANTICIPATED FUTURE STANDARDS, MADE TO GEN A WALL THICKNESS WHICH IS THE HIGHEST CLASSIFICATION IN EUROPE. OTHER WINDOW FRAMES TYPICALLY OFFER 3 OR 5 CHAMBERS AND ARE USUALLY 70MM WIDE, R² HAS 9 CHAMBERS AND IS 100MM WIDE, RESULTING IN SUPERIOR THERMAL, ACOUSTIC, STRENGTH AND SECURITY PERFORMANCES.



9

CHAMBER DESIGN

RECYCLED

MATERIAL USED

UNIQUE STYLES

INDIVIDUALITY.

STYLES

R² CAN BE MADE INTO MANY STYLES INCLUDING OPEN-OUT WINDOWS, SHAPED WINDOWS, FIXED WINDOWS, FRENCH WINDOWS, BAY AND BOW WINDOWS, ORANGERIES, CONSERVATORIES, SINGLE AND FRENCH DOORS. THE POSSIBILITIES ARE ENDLESS! FULLY PERSONALISE WITH OUR RANGE OF UNIQUE COLOUR OPTIONS AND HARDWARE.

OPEN-IN AND OPEN-OUT DOOR SOLUTION

AVAILABLE IN A WIDE RANGE OF STYLES, OUR STYLISH DOOR SYSTEMS ARE SUITABLE FOR BOTH OPEN-IN AND OPEN-OUT APPLICATIONS. DESIGNED WITH PERFORMANCE AND FLEXIBILITY IN MIND, EACH DOOR IS AVAILABLE IN SINGLE AND DOUBLE CONFIGURATIONS MAKING THEM IDEAL FOR ANY PROPERTY.



OPEN-IN DOOR



10
BESPOKE COLOURS

NO FUSS
MAINTENANCE
FREE

R²

OPEN-OUT DOOR

PLAN²

HAVE YOU MADE YOUR CHOICE?

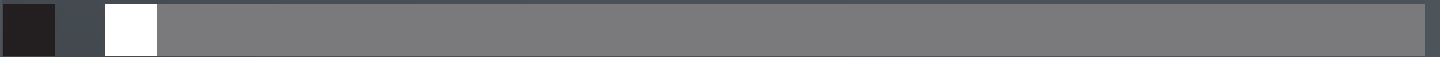
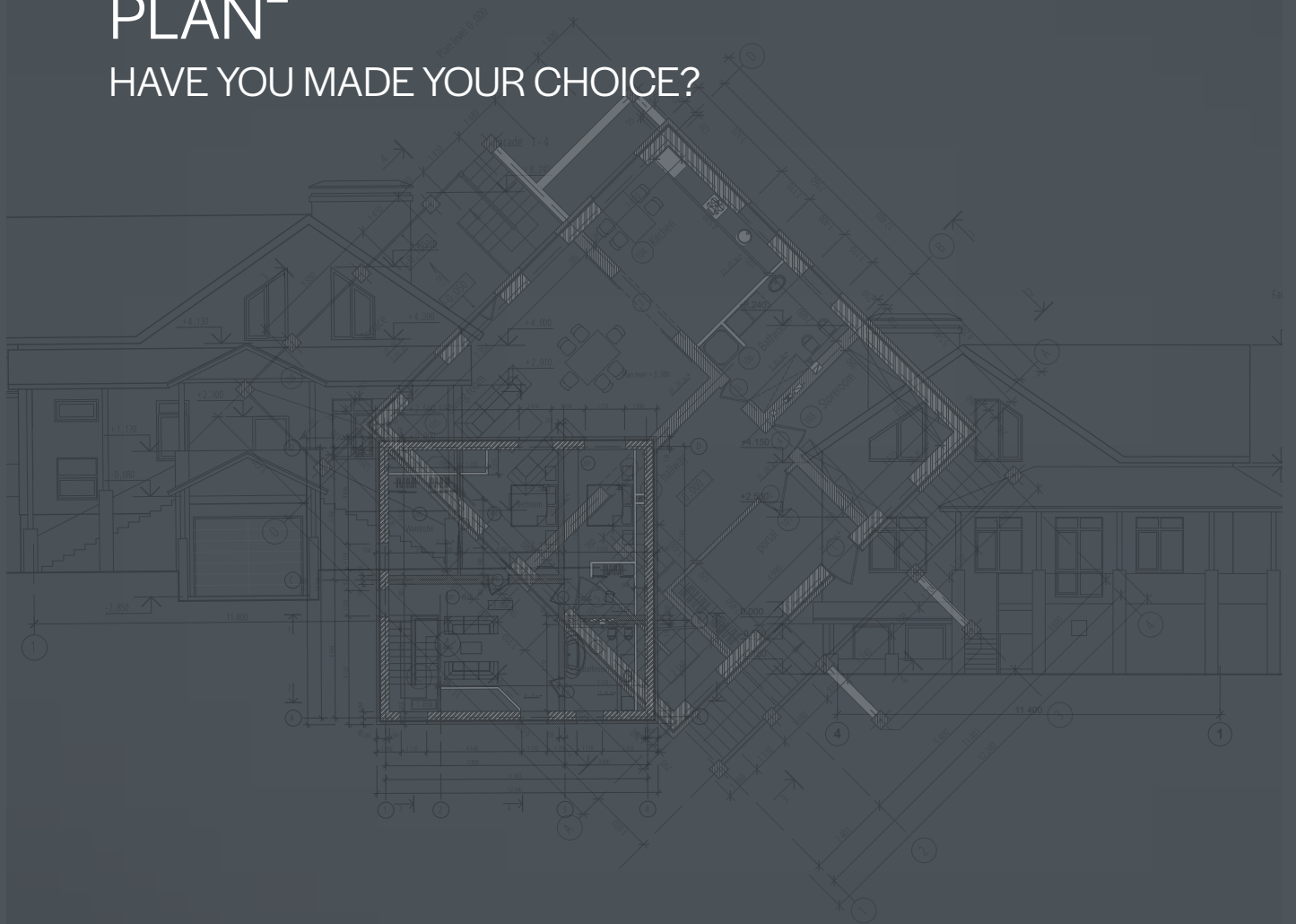

NOT QUITE WHAT YOU'RE LOOKING FOR?

THE RESIDENCE COLLECTION COMPRISES OF TWO OTHER SYSTEMS. TAILORED TO SUIT ANY PROJECT, THE BEAUTY IS THEY ALL LOOK IDENTICAL FROM THE OUTSIDE, THE UNIQUE AESTHETICS ARE INTERNALLY, CHOOSE YOUR DESIGN FEATURE.



Smooth flush interior and 75mm frame depth - ask for Residence 7.



Decorative timber interior and 100mm frame depth - ask for Residence 9.









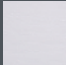
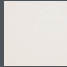

THE
RESIDENCE
COLLECTION

R²

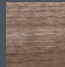
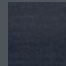
INSIDE COLOUR

OUTSIDE COLOUR

	GRAINED WHITE	CLOTTED CREAM	PAINSWICK	ENGLISH OAK	IRISH OAK	SILVERED OAK	ECLECTIC GREY	VINTAGE CREAM (UNFOILED)	CHALK WHITE (UNFOILED)	NO. 38 GREY (UNFOILED)
GRAINED WHITE										
CLOTTED CREAM										
PAINSWICK										
ENGLISH OAK										
IRISH OAK										
SILVERED OAK										
ECLECTIC GREY										
VINTAGE CREAM (UNFOILED)										
CHALK WHITE (UNFOILED)										
NO. 38 GREY (UNFOILED)										

THE RESIDENCE
COLLECTION

R²



#R2journey

Get in Touch

T: 01452 300912 E: journey@residencecollection.co.uk W: www.residencecollection.co.uk

RESIDENCE COLLECTION, RESIDENCE ² AND R² ARE REGISTERED UK TRADE MARKS OF WINDOW WIDGETS (2006) LIMITED